



# WHITELEY Matters

Autumn 2008

## Whiteley parish council under fire over survey forms

**THREE origin and destination surveys aimed at easing future travel in and out of Whiteley were carried out on September 9.**

The one-off surveys were undertaken under supervision of the local police traffic management team.

Meantime, Whiteley Parish Council was criticised by local councillors for treading on the County's toes by prematurely sending out survey forms which included requests for similar information.

**•Full story in P2 of main edition.**



### Whiteley on-line

If you would like to get "on-line" with members of the community in a friendly, non-threatening atmosphere to discuss issues about living in Whiteley, Hampshire or any other topics of interest then there is only one place to go.

Log on to Whiteley Community Forum at [www.whiteleyforum.net](http://www.whiteleyforum.net)

### Thoughts of spring

Spend an enjoyable afternoon planting bulbs among the trees and make the place where you live come alive with spring flowers.

All ages are welcome at a bulb planting and litter pick between 1.30pm and 4.30pm at Maryat Way, Whiteley on Thursday, October 30.

The event is staged by the partnership of Fareham Borough Council, Persimmon Homes and Swaythling Housing Association.

### Queen's Awards

Hampshire County Council wants nominations of volunteers of all types for the Queen's Award for Voluntary Service.

Forms may be obtained from [www.queensawardvoluntary.gov.uk](http://www.queensawardvoluntary.gov.uk) or phone 020 7781 2397.

# Emergency use plan being drawn up for Whiteley bus link route

**A PLAN is being put together for the use of the Yew Tree Drive/Botley Road bus link (pictured) in emergencies.**

Apart from the use by emergency vehicles, the link is available to all traffic when the police use their powers under the road traffic act to instantly override the traffic regulation order.

This could be done in cases where there are problems either side of the link necessitating its opening to all vehicles, such as problems at the M27 junction 9 or indeed elsewhere in Whiteley, Burridge, Swanwick or Park Gate.

It is important to work out what signage will be used to warn motorists of the problem and that the link is available.



Possibilities include variable message signing or simple signage which can be manually deployed at very short notice.

A draft plan has been completed which the police have to approve before more detailed consultation.

Once the plan has been agreed with the police, the County Council will consult all interested parties before the plan's adoption.

We will report progress in a future edition of Whiteley Matters.

## Whiteley children get priority in admissions review

**A REVIEW of the admissions policy for the Sarisbury Infant and Sarisbury Church of England Controlled Junior Schools has been carried out at the request of County Councillor Seán Woodward.**

A specific clause (3A) has been added (see panel) effective from September 2009 admissions.

County Councillor Woodward said: "I am delighted at this change of heart in response to my request by the Hampshire Admissions Forum.

"This means that Whiteley children with siblings at either school now enjoy a higher priority even than children living in the catchment area or those who live outside the catchment area, but not in Whiteley and have siblings at the school.

"I believe this is only fair as it would be very

difficult for Whiteley residents to take each of their children to different primary schools if they are unable to gain admission to Whiteley Primary School due to the lack of places.

"I am also pleased to note that there has never been a problem

with children leaving Sarisbury Infant School and joining Sarisbury Junior School.

"However, if there ever was I am assured that they would have a very strong case at appeal."

He added: "It is not surprising that the Sarisbury Schools are so popular with Whiteley residents due to the very good Ofsted ratings that they receive.

"In fact, the Junior School is to be congratulated on recently receiving the best possible rating of outstanding – the best in the area."

**CLAUSE 3A  
'Children living within the Whiteley catchment area who at the time of application have a brother or sister (including children living as siblings in the same family unit) on the roll of Sarisbury Infant or Junior school and who will still be on roll, at either school, at the time of the sibling's admission'.**

# Dickens of a job, but start nears on new play area

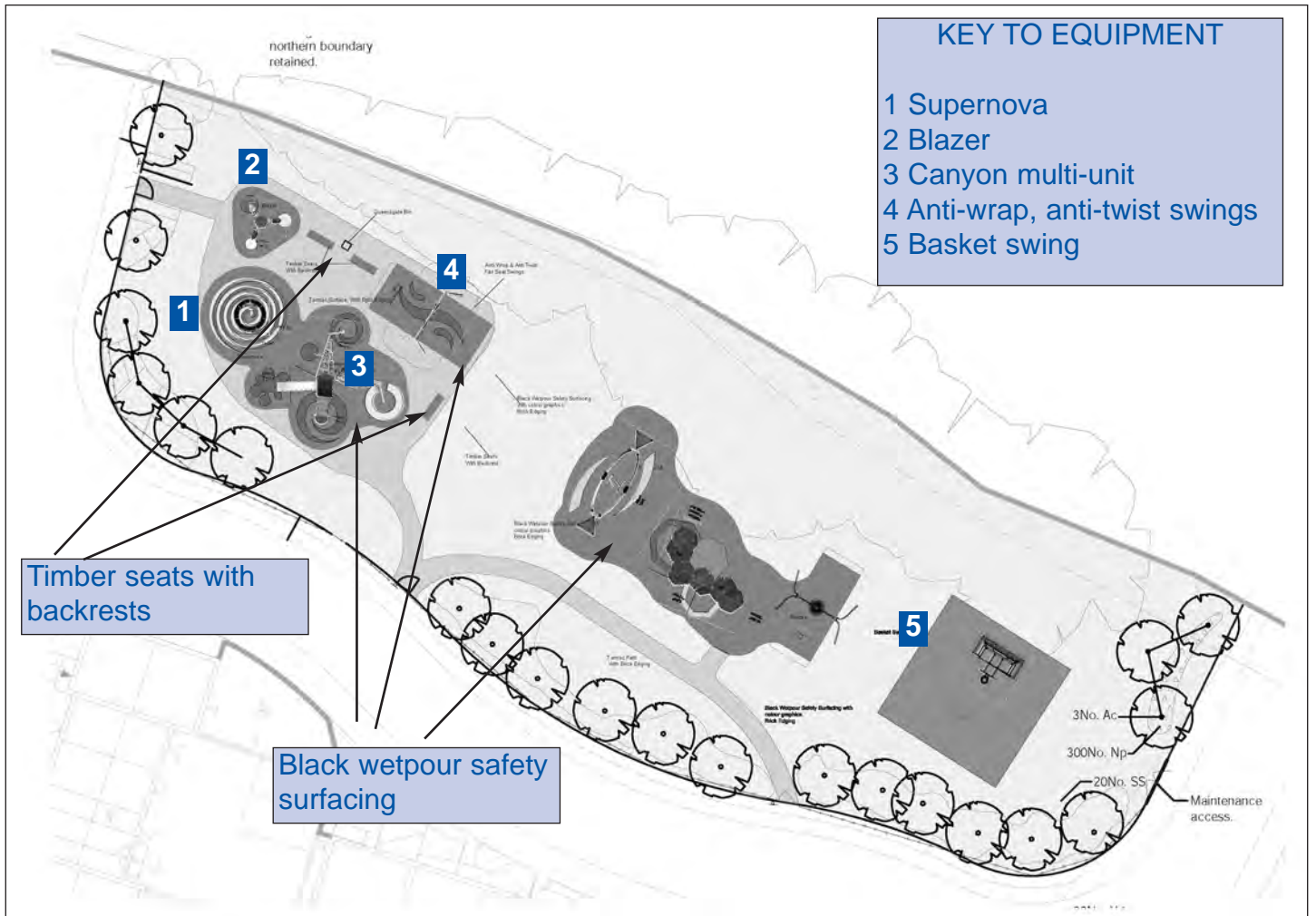

The Blazer



Supernova



Multi-wrap swing



The Canyon



**INITIAL** proposals for the long-awaited play area in the new Persimmon development off Dickens Drive are now being priced up ready for implementation.

Realistically, the play equipment (pictured) should be completed by Persimmon ready for summer 2009.

The cost is about £100,000, with £50,000 being contributed from the proceeds of the land that was sold to build the doctors' surgery on Yew Tree Drive and Persimmon contributing the other £50,000.

Councillor Seán Woodward said the reason for a joint project was to provide a much better facility than would otherwise be provided by the level of development in the Persimmon building scheme.

The plans as currently envisaged provide play areas for younger and older children, plus a kickabout area with a basketball net which has been long promised to residents.

*In Touch* is published by Sarisbury & Park Gate Conservatives, 8 Persian Drive, Whiteley PO15 7BJ and printed by and printed by Bishops Printers Limited, Fitzherbert Road, Farlington, Portsmouth PO6 1RU.